

# Link<sup>®</sup>

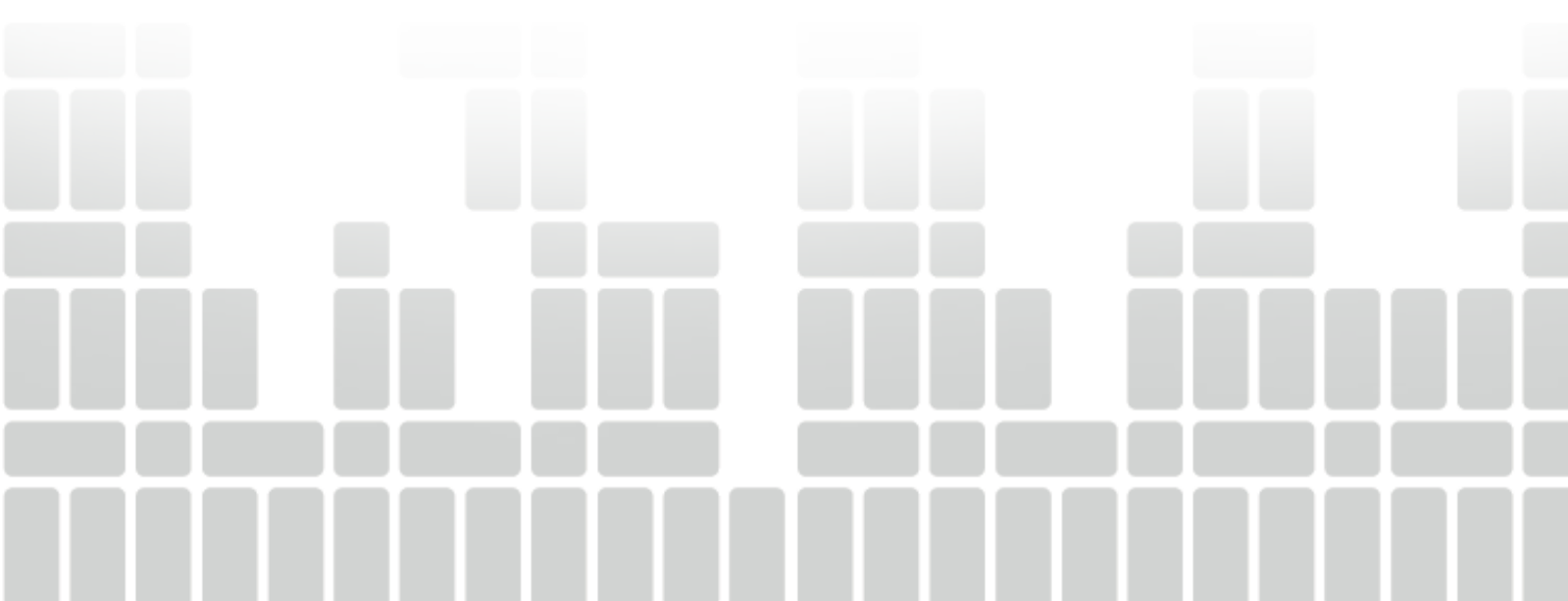

## ▶ Manual de instalación - Link

### Piezas:

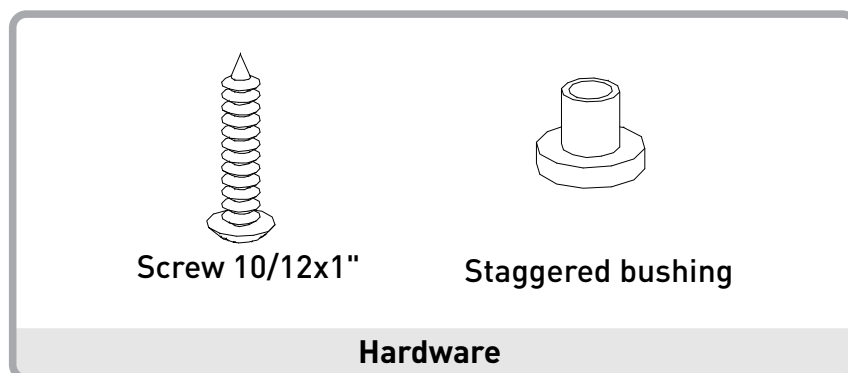
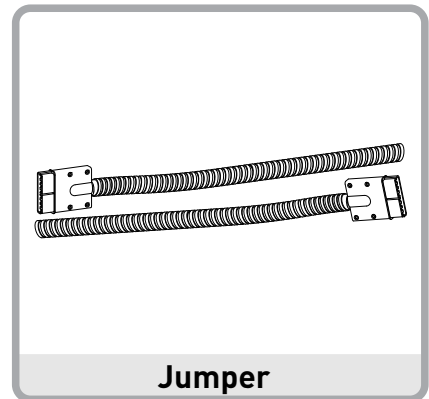
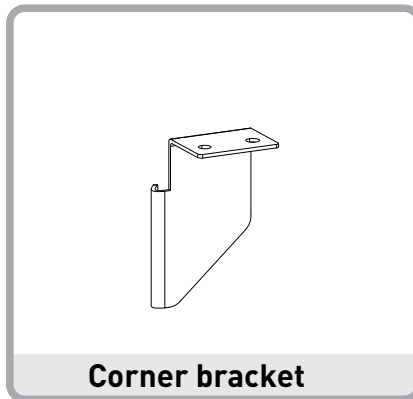
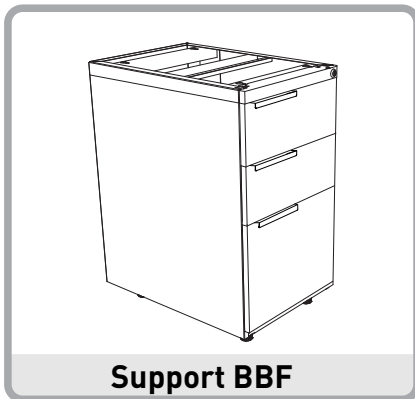
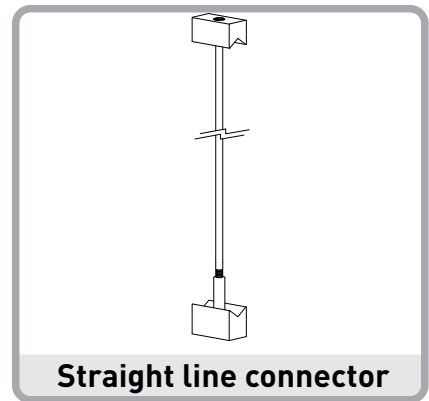
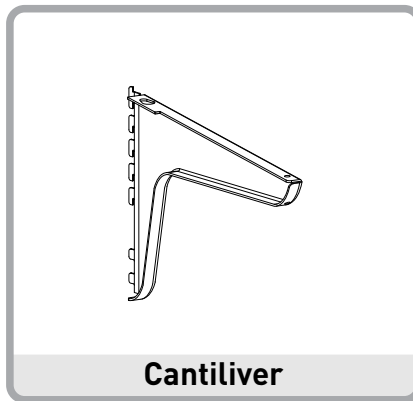
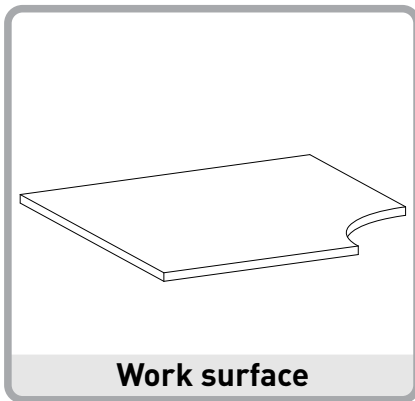
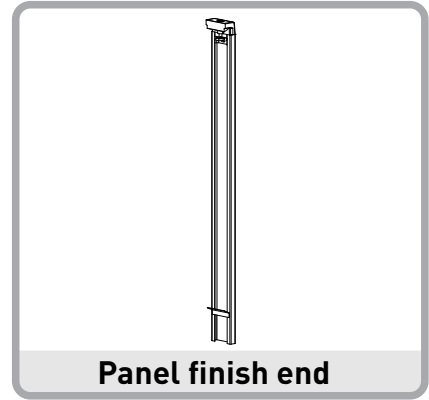
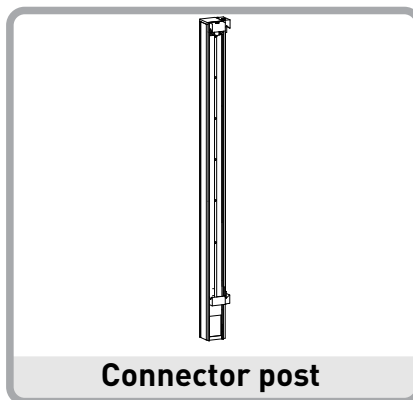
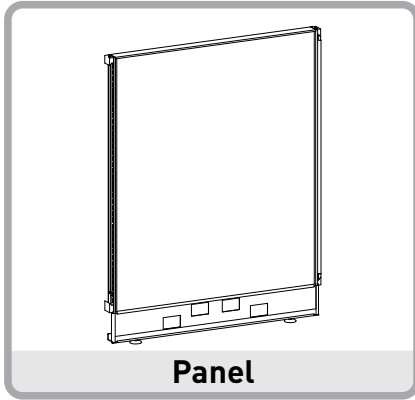

## ▶ 1. Jumper Installation

1.1 Jumpers that pass a connector post must be inserted through the perforations prior to making the connection to the Panels, once the Jumper is inserted to the raceway it must connect to the power harness

Recall that the harnesses are located at the bottom of the Panels and that is where the Receptacles should be placed with the wiring system. The Receptacle is fixed, you will use Screws 10/12x5/8".

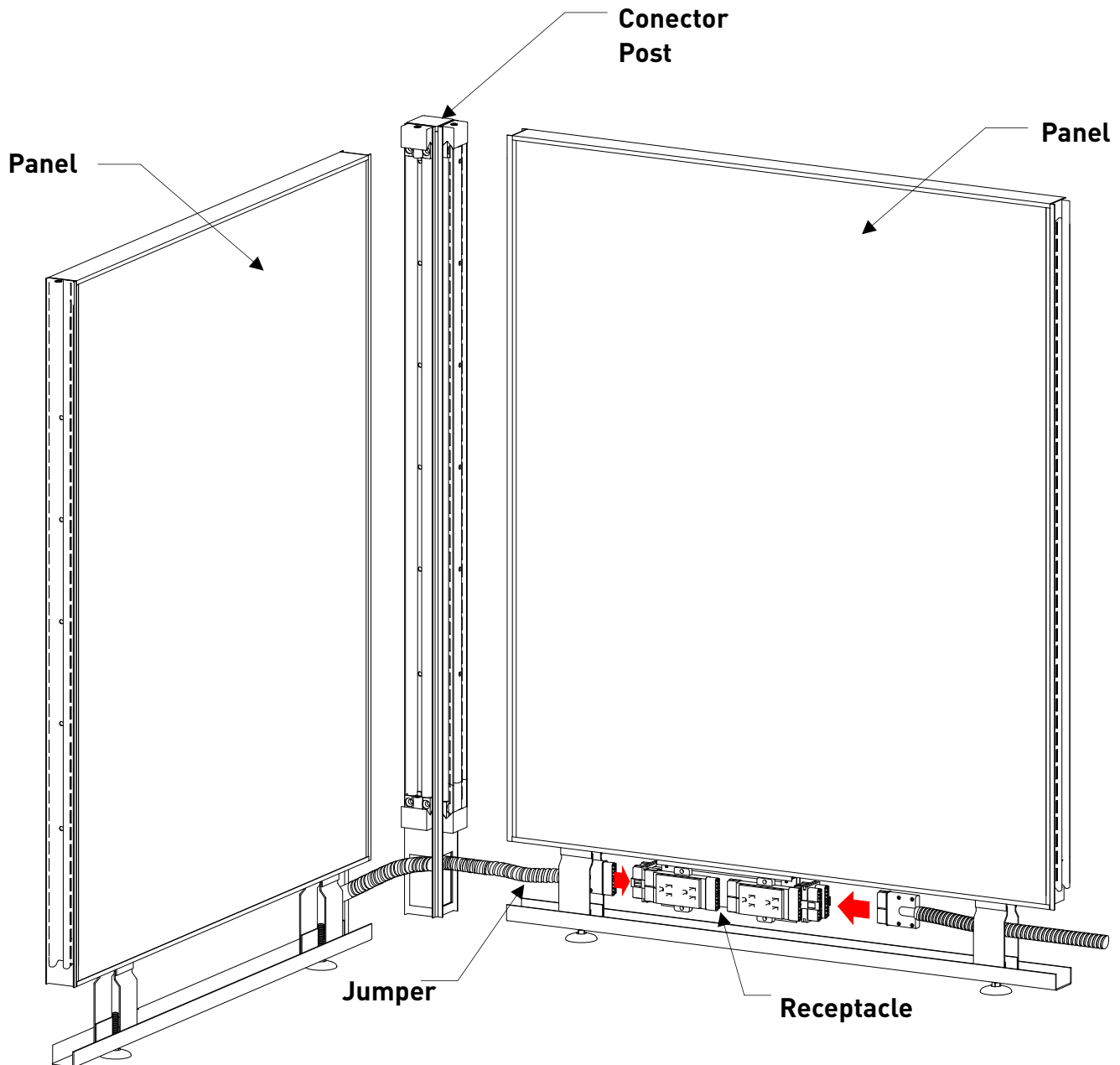
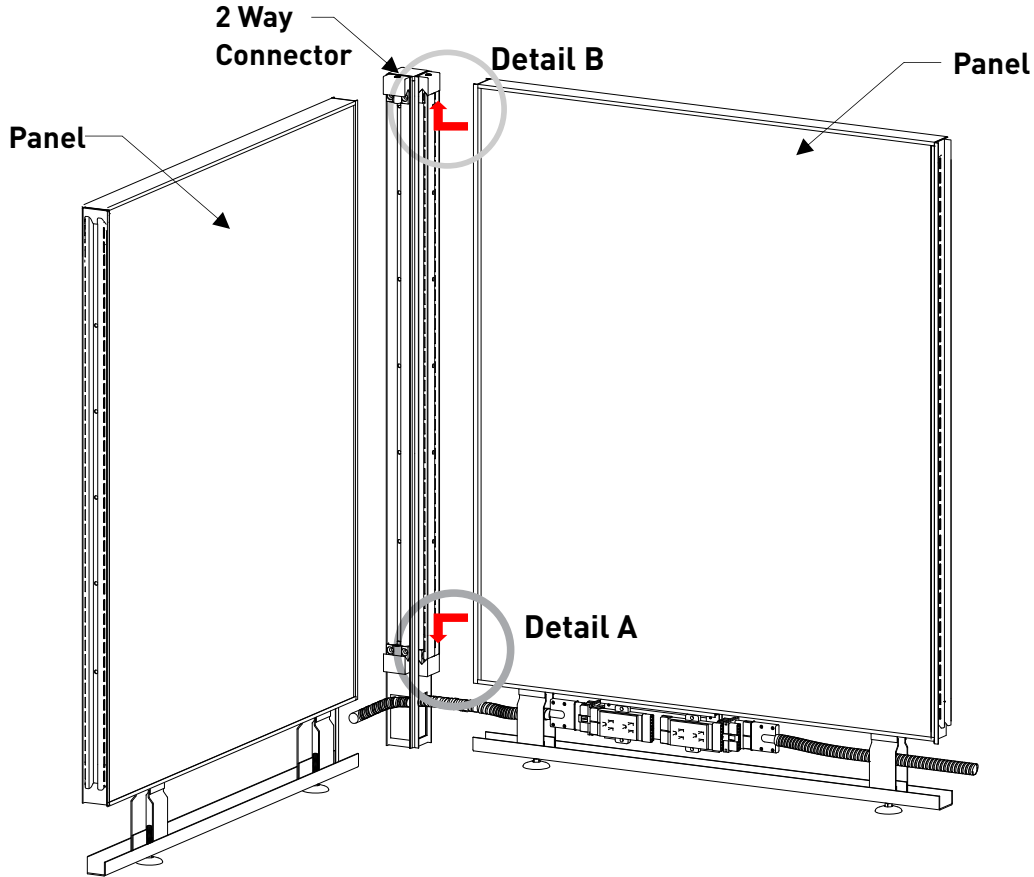

Image 1.1

## 2. Connector Post to Panel Installation

Image 2.1



2.1 Once the **Jumpers** have been conducted trough post and raceway, the connector post will connect the **Panel** by using the top and bottom **Wedge Blocks** on the post.

Detail A

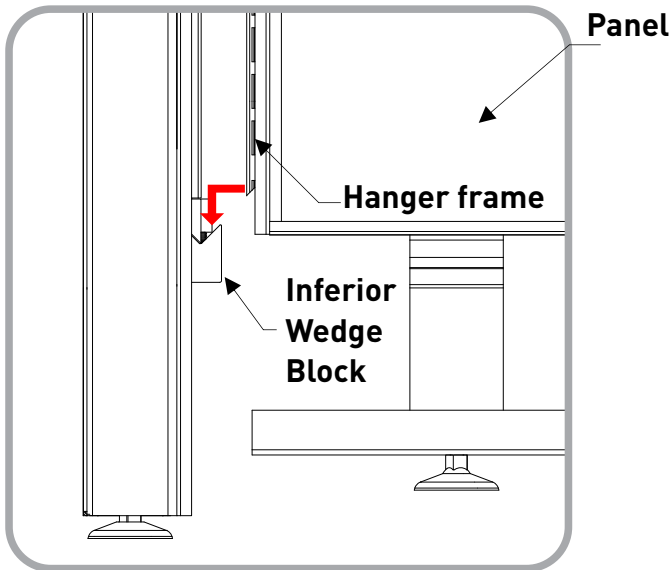

Slide the inferior part of the **Hanger frame** to the **Inferior wedge block**.

Detail B

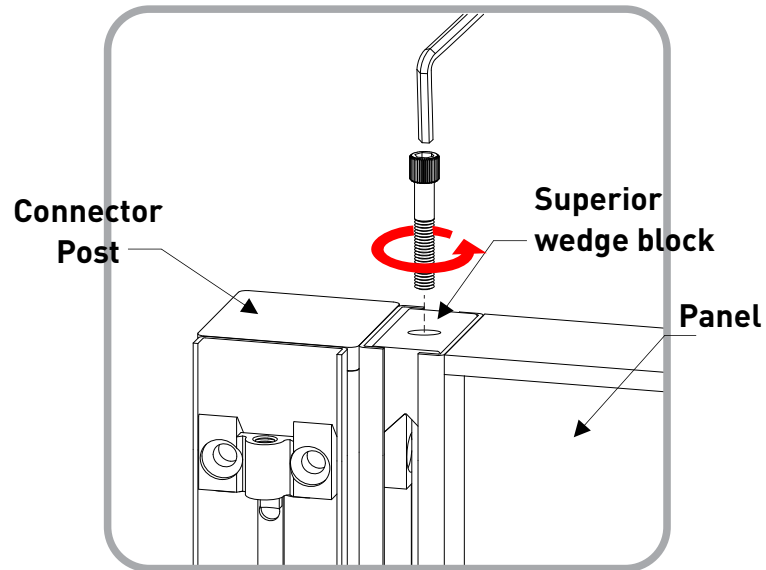

Align the **Hanger frame** on the **Panel** and post and connect using the **Superior wedge block** and screw using the allen wrench.



## ▶ 4. Raceway Cover Installation

4.1 To install the Raceway cover you must use the clips on the lower part of the panel Raceway. As show on Image 4.1

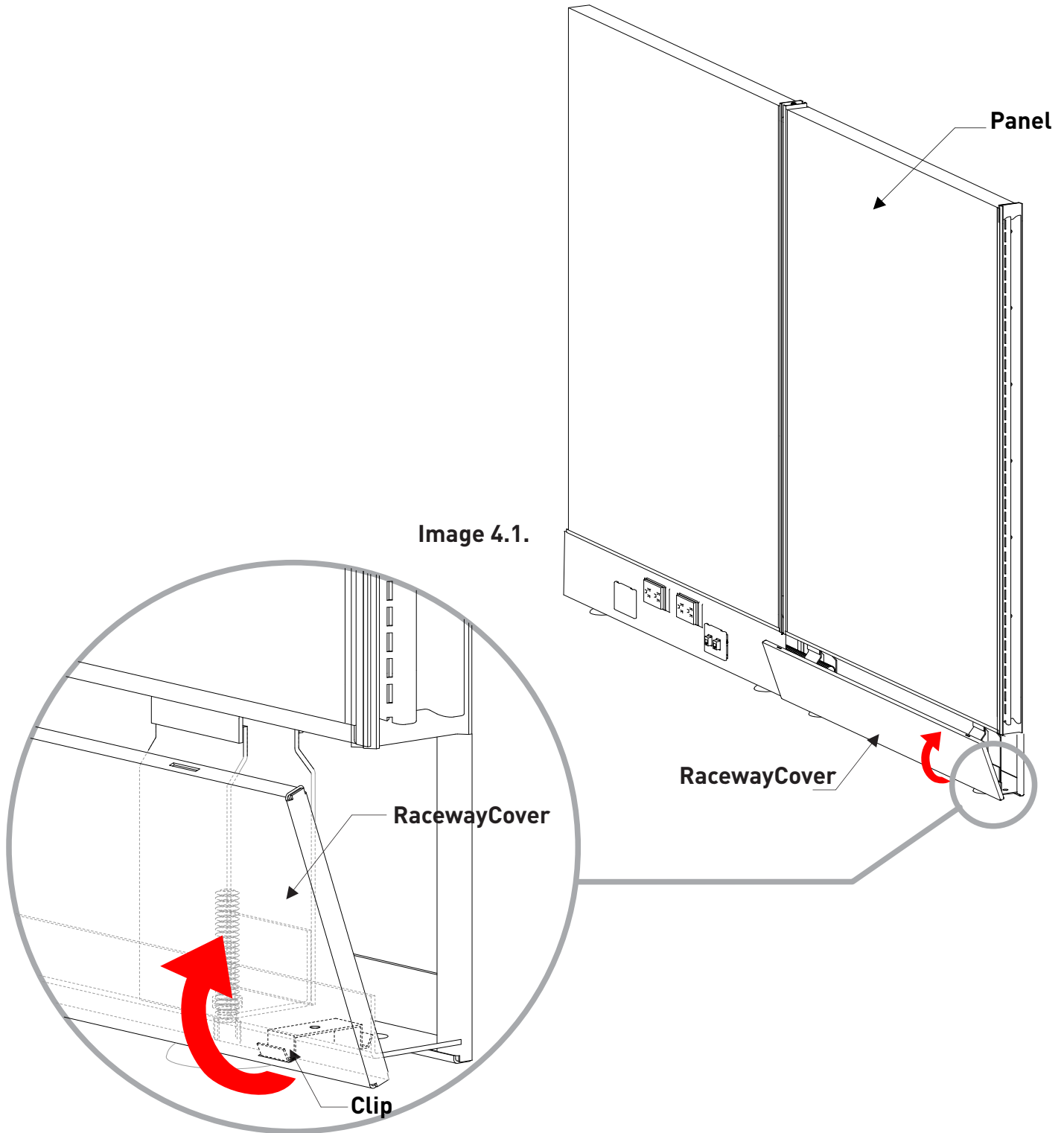

## ► 5. Work Surface Installation

5.1 To install Work surfaces you will need to place Cantilevers and Brackets at 27 3/8" high to the upper part of the hardware, then fix the surfaces. As shown on Image 5.1. After installing the Worksurfaces, you must install the Union Flat Brackets, between the Worksurfaces.

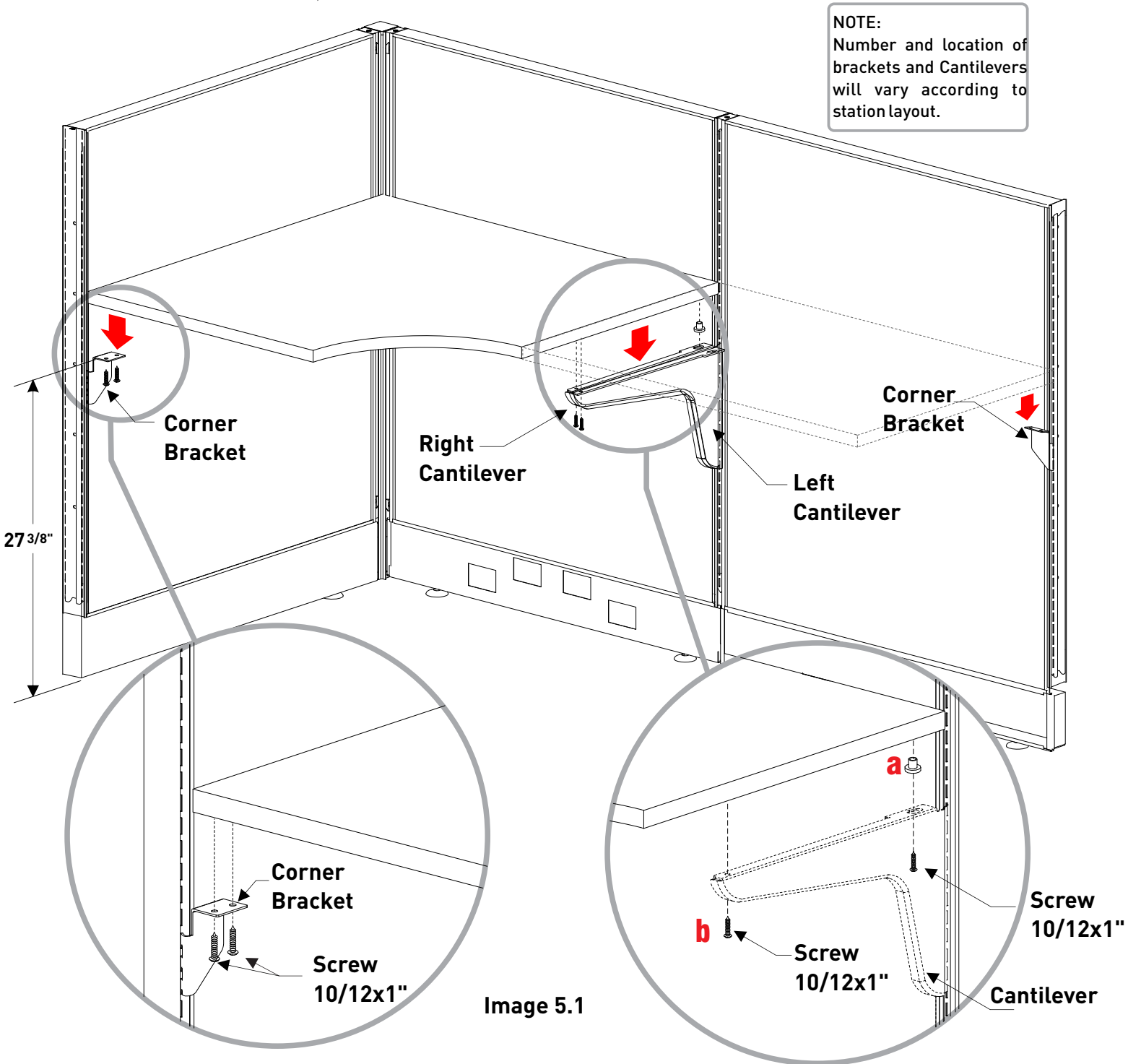

To fix the Surface to the Cantilever use a) Staggered bushing, b) Central Bushing, c) Leveling set screw.

## ▶ 6. Support Pedestal Installation

6.1 To install Support Pedestals to a Work Surface you must first remove the drawers by following these steps:

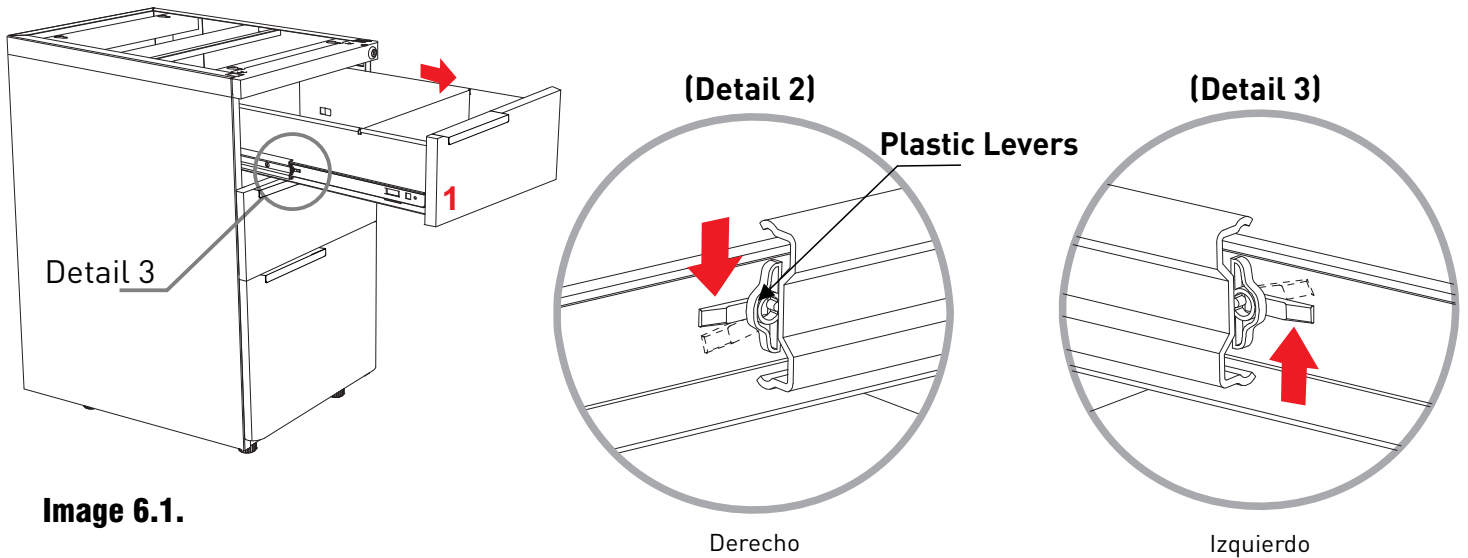

**Image 6.1.**

To begin you must remove the top drawer ( ) and once you can see the **Plastic Levers** you must lower the lever on the right rail (Detail 2) and move the lever from the left rail up (Detail 3) once you've done this the drawer can be removed from rails (repeat the same process for the next drawer)

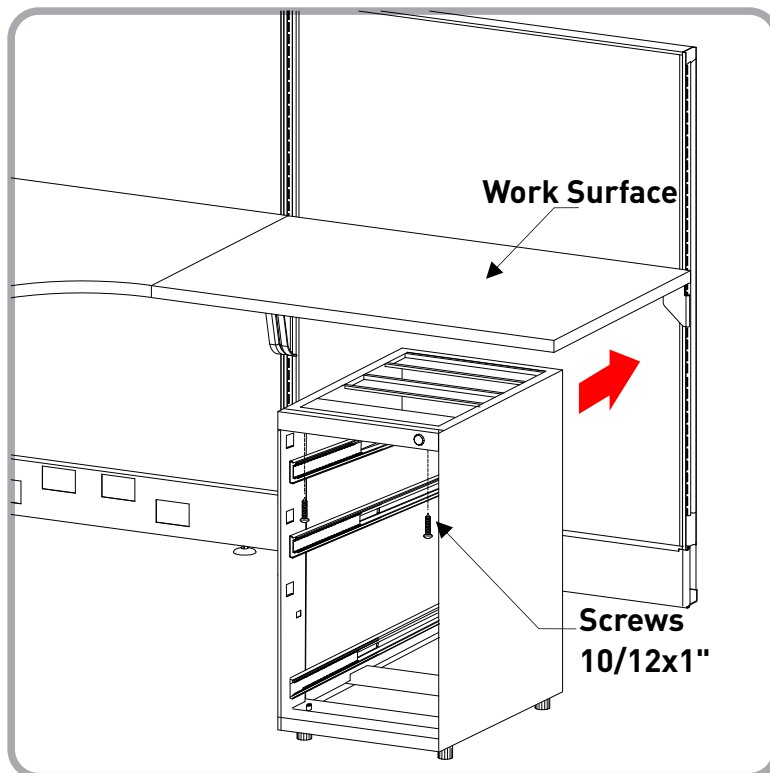

6.2 After removing the drawers, you must place the structure of the drawer underneath the **Work Surface**, and use 10/12x1" screws to fix the storage unit to the **Work surface**. As show on Image 6.2

**Image 6.2.**



## ▶ 6. Support Pedestal Installation

6.3 After installing the strong pedestal structure, the drawers must be placed once again on their corresponding rails, by taking the drawer slide rail and inserting to the drawer rail. Make sure that the bearings on the rails are at the front. (Detail 5)

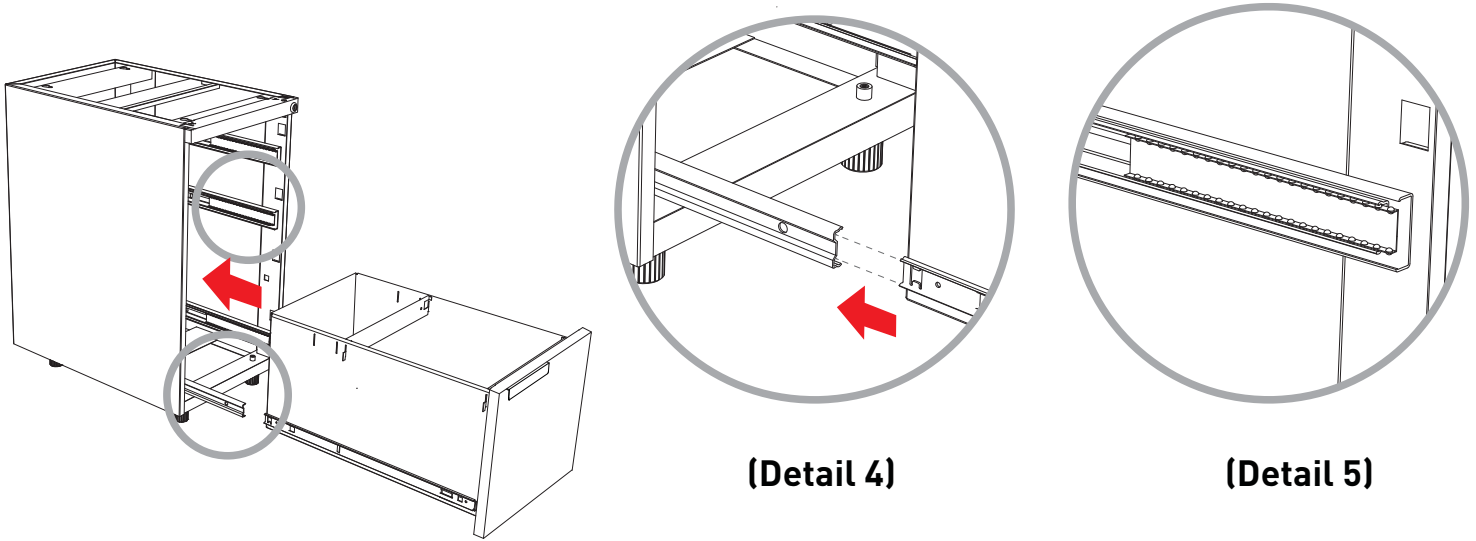

Image 6.3.

The drawers must be aligned with the front of the **Work Surface** (Image 6.4)

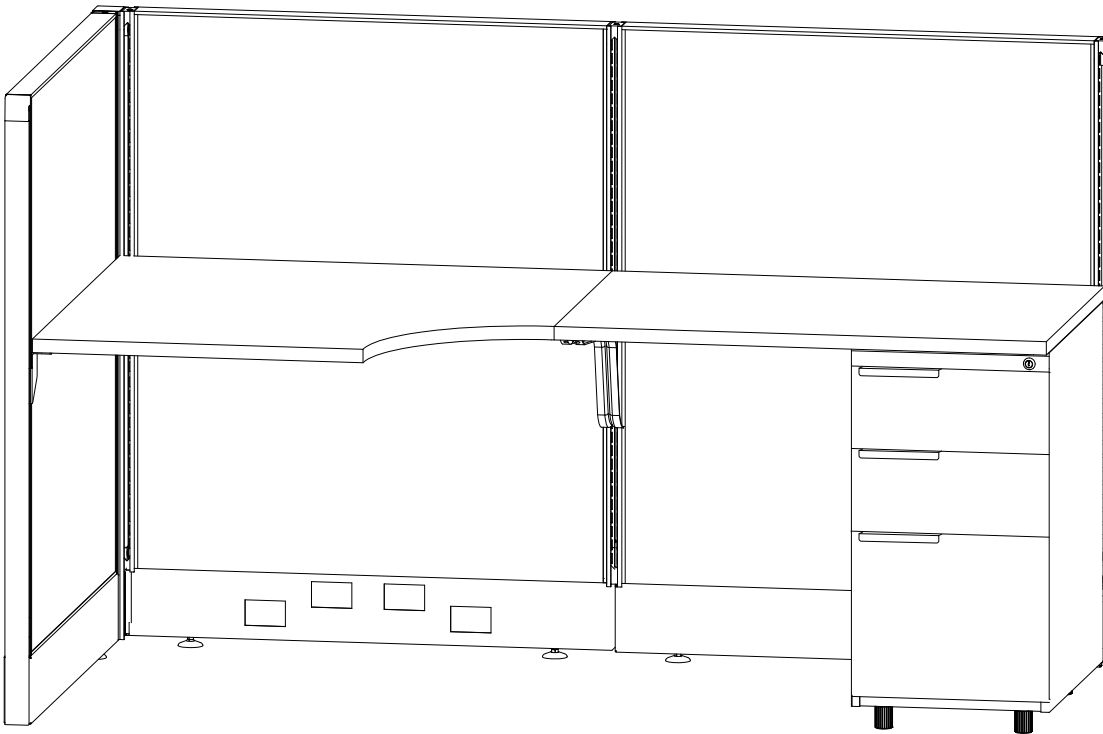

Image 6.4.

## ▶ 7. Installing Panel Finished Ends

7.1 To install the Finished End to a Panel you must slide the Angled Bracket on the Finished End to the Hanger frame on the Panel (Detail A), then you need to align the top of the Finished End by adjusting the Wedge Block with the screw until fixed. (Detail B)

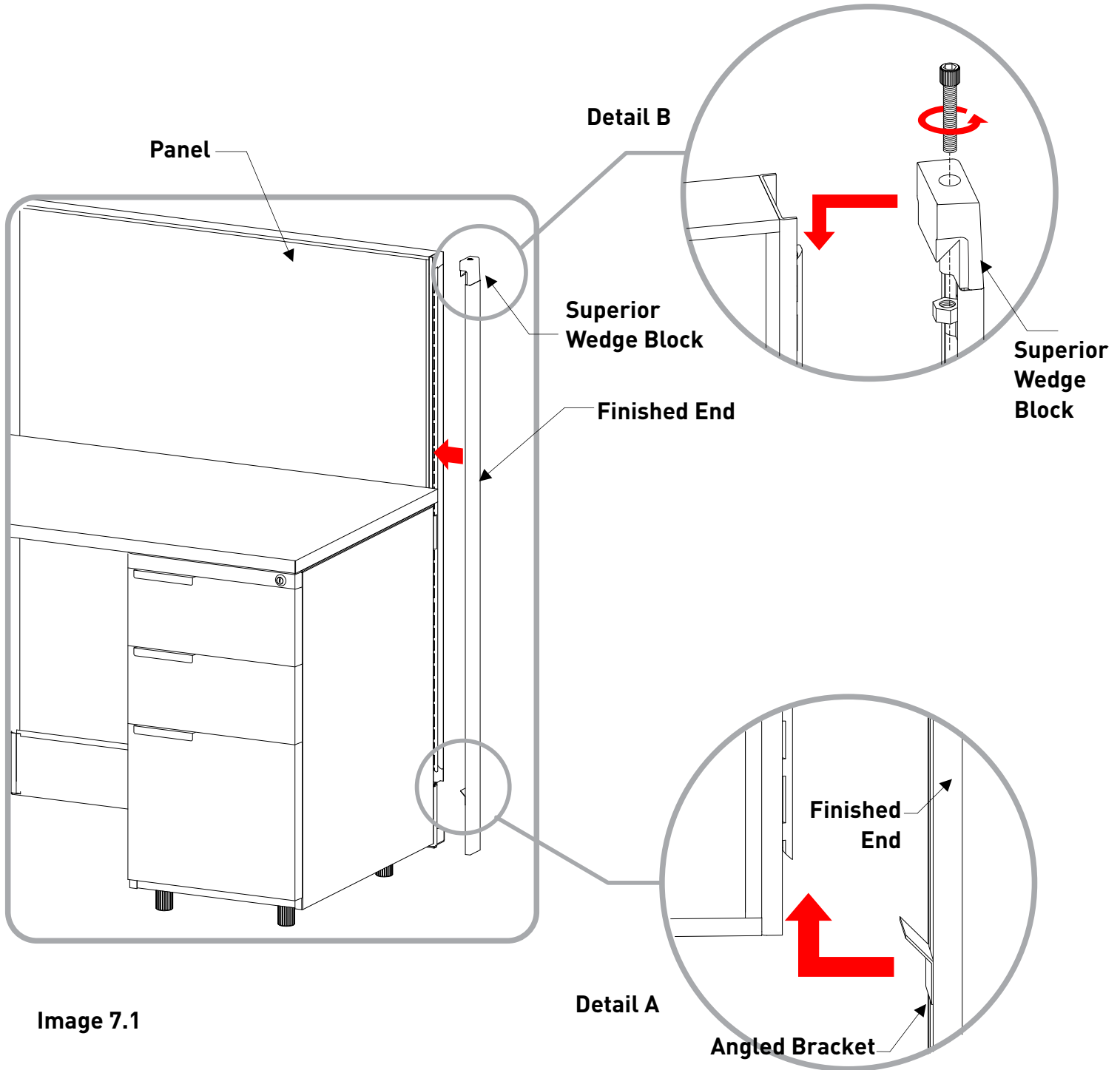
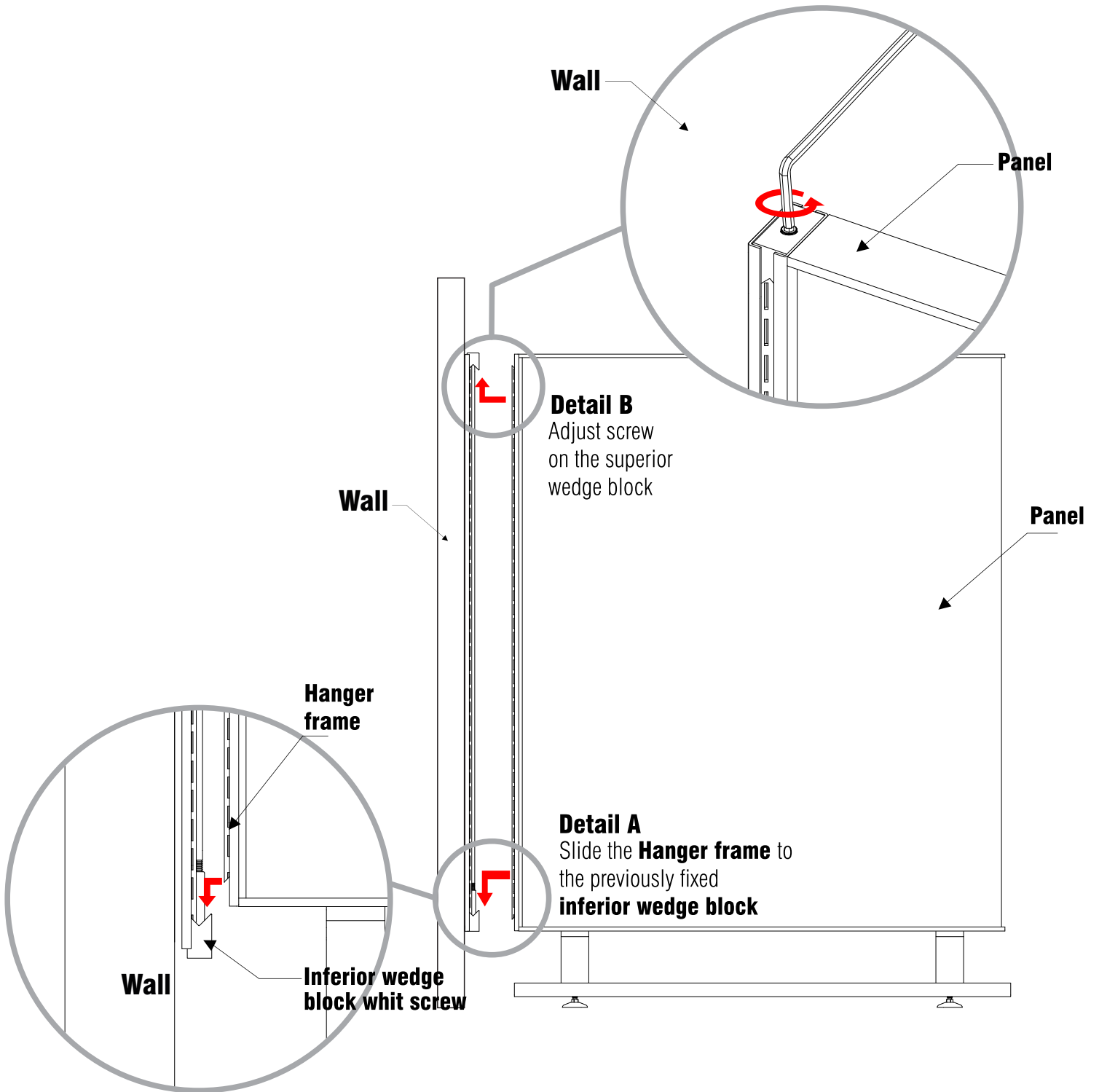

Image 7.1

## ▶ Wall start installation

Once joined, place the panel and fix it using superior and inferior wedge blocks.



# Additional Items

## ▶ Wall start installation

---

Join the wall start with the hanger frame using 10-12 x 1" screws.

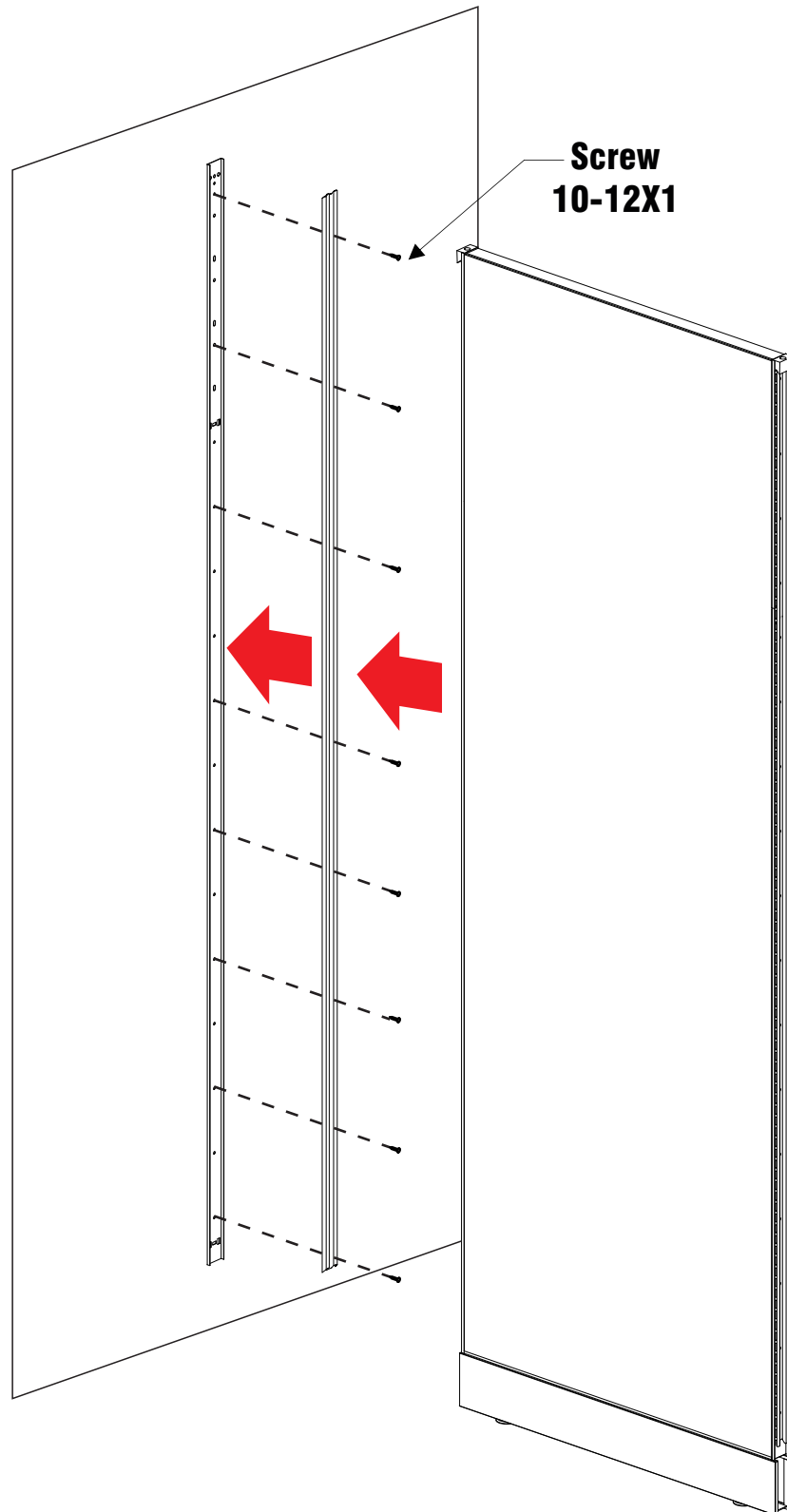

# ► Installation Manual

## LINK SLIDE DOOR

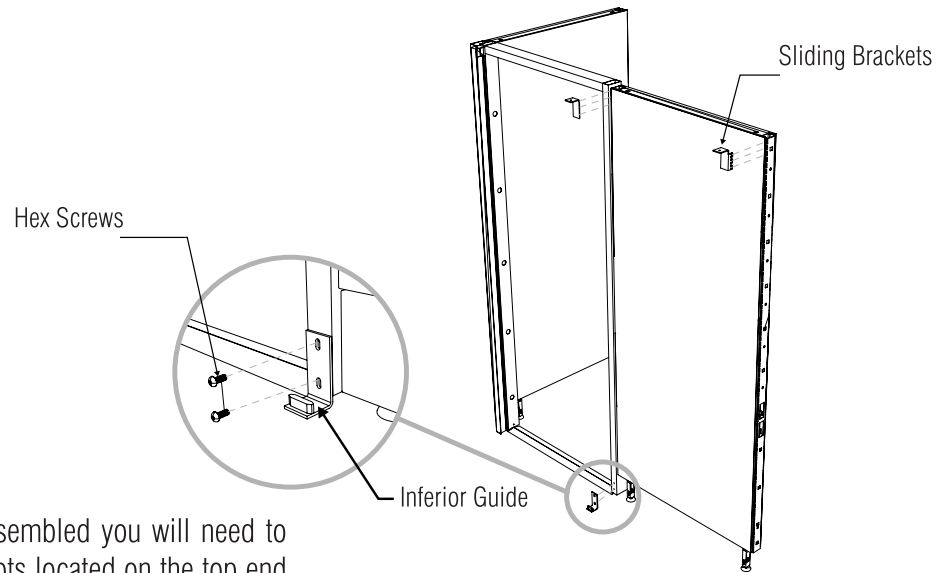

1. Once the panel is completely assembled you will need to mount the sliding brackets on the slots located on the top end of the panel, these will be supporting the sliding rail.

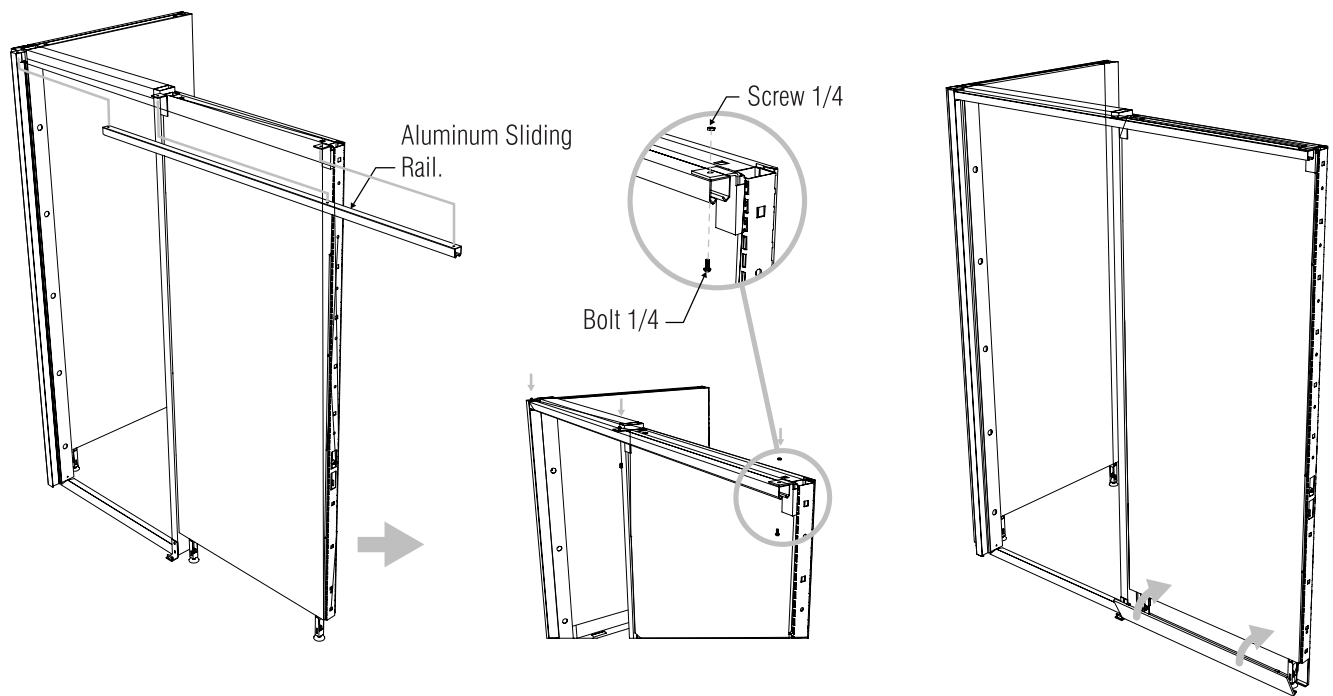

2. Once the brackets are placed you will need to assemble the aluminum sliding rail on to the mounted brackets, this piece will be held in position and connect on 3 different locations using the 1/4 screw and nut provided (see detailed image), you must fix the aluminum rail at all locations for proper and correct installation.

3. Fix the panel raceway cover on to the panel.

# Installation Manual

## LINK SLIDE DOOR

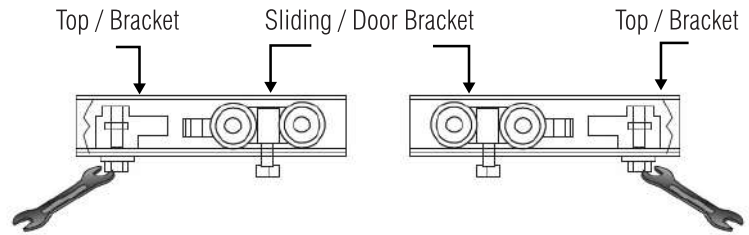
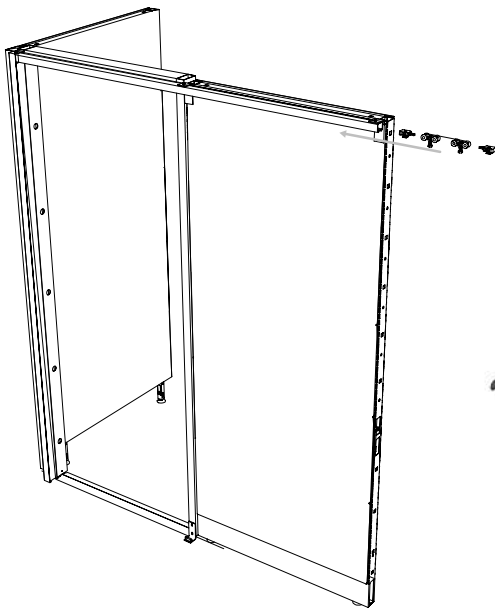

4. Insert sliding elements into the aluminum rail as shown; these must then be fixed and adjusted prior to mounting the door.

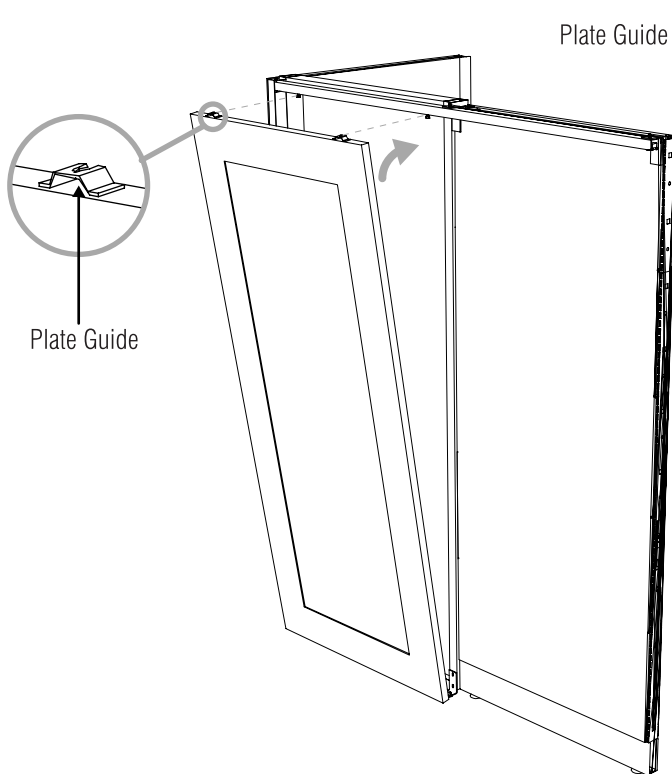

5. Door will need to be mounted on to sliding structure,

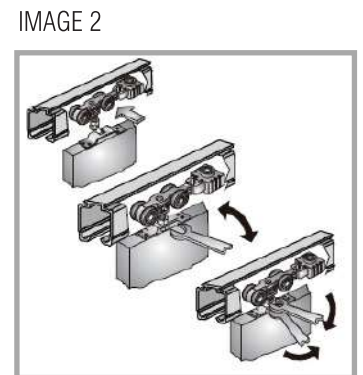
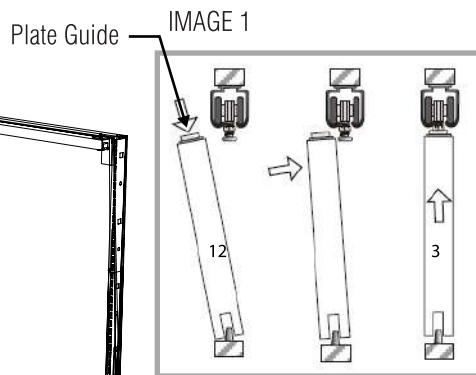

Diagram that shows how to adjust the sliding elements to level door.

To install the door you will need to perform 3 movements.

1. You will guide the door using the door guide that is at the bottom of the door frame.
2. Locate the door sliding elements and align accordingly to the door metal plates located on the door edge banding.
3. Adjust sliding elements as necessary to level door.

# ► Installation Manual

## LINK SLIDE DOOR

---

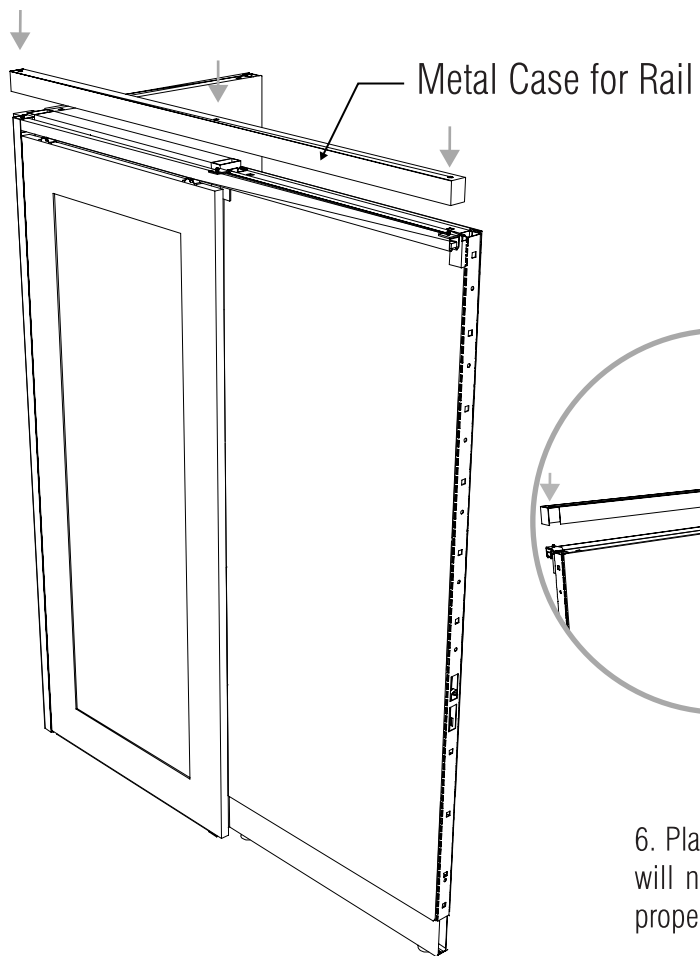

6. Place the metal cap that will hide the sliding structure, you will need to make sure that the perforations are aligned for proper installation.